

10/6/2006

31407

FORD EXPLORER / SPORT TRAC

**GROSS LOAD CAPACITY WHEN USED AS A WEIGHT CARRYING HITCH: 3500 LBS. TRAILER WEIGHT & 350 LBS. TONGUE WEIGHT.
GROSS LOAD CAPACITY WHEN USED AS STRAIGHT LINE PULL: 9000 LBS. MAX. LINE PULL.**

DO NOT EXCEED VEHICLE MANUFACTURER'S RECOMMENDED TOWING CAPACITY.***

Parts List			
ITEM	QTY	PART NUMBER	DESCRIPTION
1	4	1/2 - 13 x 2 1/4	CARRIAGE BOLT
2	2	CM-SP1	.250 x 1.50 x 2.00" SQUARE HOLE SPACER
3	4	HFN 1213	HEX FLANGE NUT
4	2	CM-31407-MT	.250" MOUNTING ANGLE BRACKET

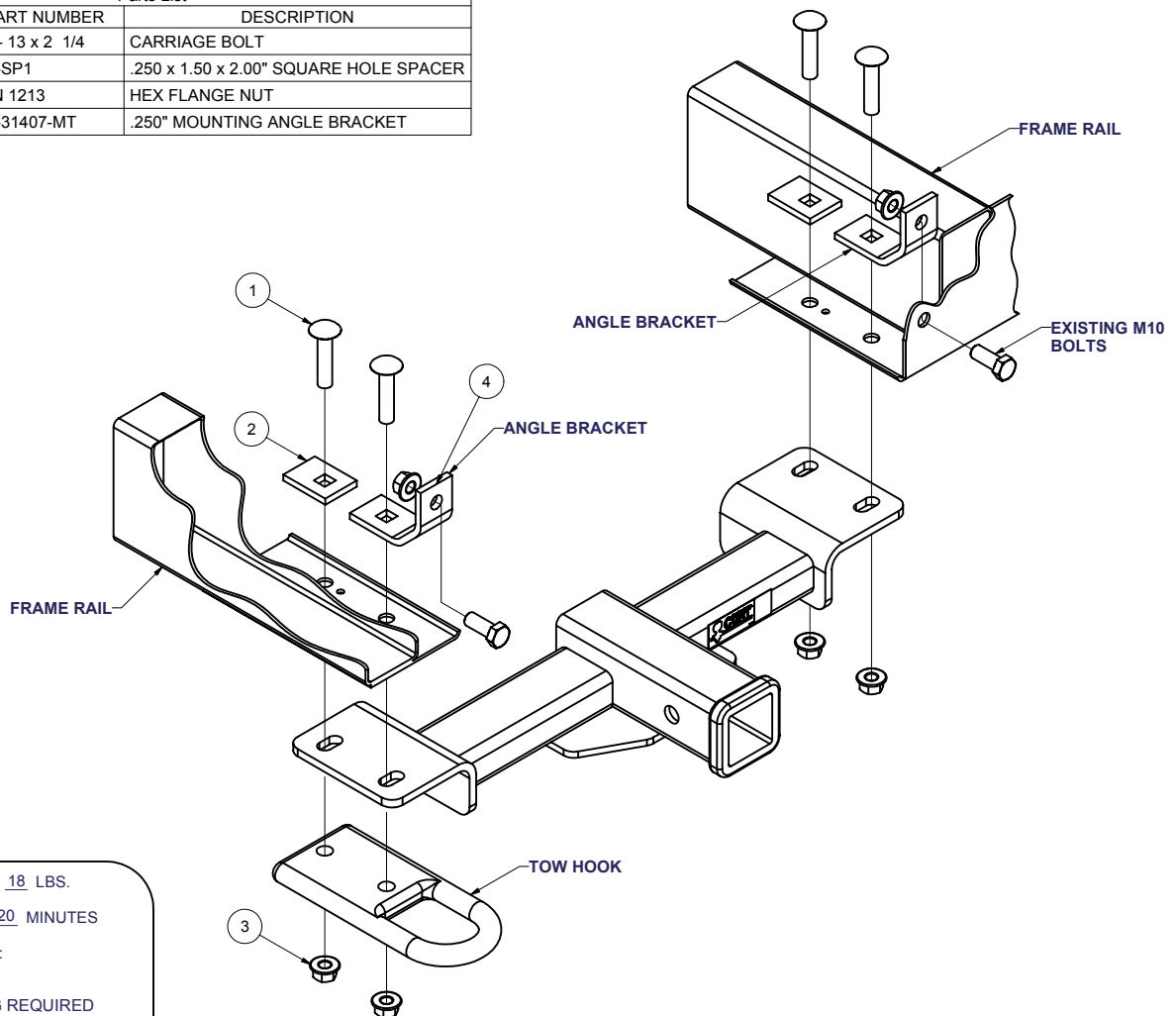

HITCH WEIGHT: 18 LBS.

INSTALL TIME: 20 MINUTES

INSTALL NOTES:

NO DRILLING REQUIRED

INSTALLATION STEPS

- 1) Remove plastic air dam and tow hooks if present.
- 2) Remove existing bumper bolts and bumper brackets. (Return bumper brackets to customer)
- 3) Install angle brackets using existing bumper bolts as shown.
- 4) Raise hitch into position and secure with 1/2" x 2 1/4" carriage bolts, spacer blocks, and flange nuts as shown.
- 5) If tow hooks are present, sandwich hitch between frame rail and tow hooks and secure with 1/2" x 2 1/4" carriage bolts, spacer blocks, and flange nuts as shown.
- 6) Torque all M10 fasteners to 53 lb-ft and all 1/2" fasteners to 75 lb-ft.
- 7) Reinstall air dam removed in step 1.

PERIODICALLY CHECK THIS RECEIVER HITCH TO ENSURE THAT ALL FASTENERS ARE TIGHT AND THAT ALL STRUCTURAL COMPONENTS ARE SOUND.