

GROSS LOAD CAPACITY WHEN USED AS A WEIGHT CARRYING HITCH: 3,500 LBS. TRAILER WEIGHT & 350 LBS. TONGUE WEIGHT.  
GROSS LOAD CAPACITY WHEN USED AS STRAIGHT LINE PULL: 9000 LBS. MAX. LINE PULL.

**DO NOT EXCEED VEHICLE MANUFACTURER'S RECOMMENDED TOWING CAPACITY.\*\*\***

Parts List			
ITEM	QTY	PART NUMBER	DESCRIPTION
1	1	1/2"	FISHWIRE TOOL
2	2	CM-SP6	.250 x 1.00 x 3.00" SQUARE HOLE SPACER
3	2	HFN 1213	HEX FLANGE NUT
4	4	M12-1.75 x 40mm	HEX BOLT
5	4	1/2"	LOCK WASHER
6	4	1/2"	WASHER
7	2	1/2-13 x 1 1/2	CARRIAGE BOLT

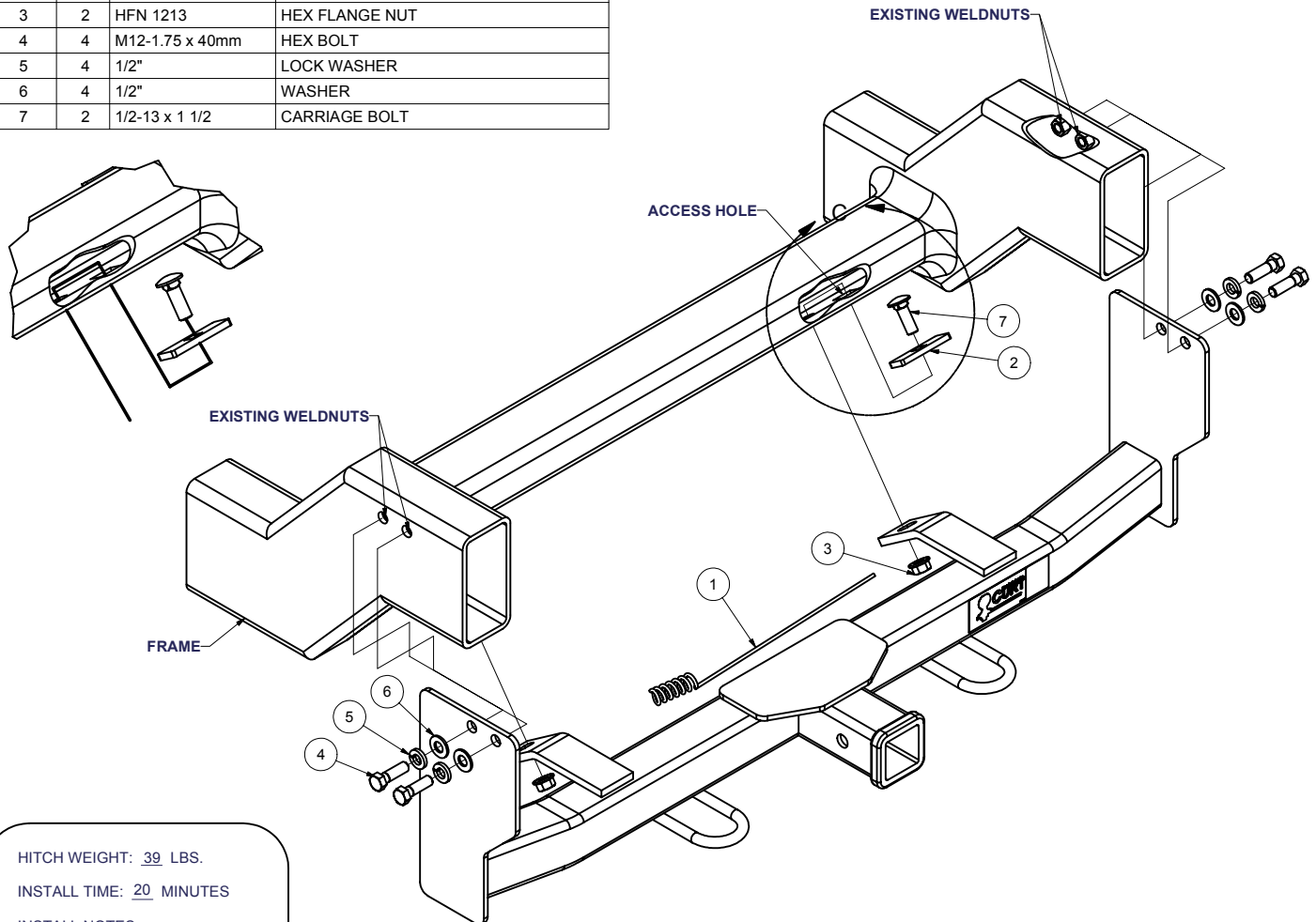

HITCH WEIGHT: 39 LBS.

INSTALL TIME: 20 MINUTES

INSTALL NOTES:

- REMOVE BUMPER SUPPORTS
- TRIMMING REQUIRED

### **INSTALLATION STEPS**

- 1) Remove both of the front bumper support brackets from the frame, return to customer.
- 2) Raise hitch into position, install hardware into frame rails (as shown).  
**\*Note: shroud must be trimmed for correct contact between crossmember and hitch tabs.\***
- 3) Fishwire carriage bolts and square hole spacers into location as shown.
- 4) Install remaining fasteners.
- 5) Torque 1/2" fasteners to 75 lb-ft.  
Torque 12mm fasteners to 59.25 lb-ft.

**PERIODICALLY CHECK THIS RECEIVER HITCH TO ENSURE THAT ALL FASTENERS ARE TIGHT AND THAT ALL STRUCTURAL COMPONENTS ARE SOUND.**