

GROSS LOAD CAPACITY WHEN USED AS A WEIGHT CARRYING HITCH: 5,000 LBS. TRAILER WEIGHT & 500 LBS. TONGUE WEIGHT.
*****DO NOT EXCEED VEHICLE MANUFACTURER'S RECOMMENDED TOWING CAPACITY.*****

Parts List			
ITEM	QTY	PART NUMBER	DESCRIPTION
1	1	CM-.375-FW	FISHWIRE TOOL
2	2	3/8 - 16 x 1 3/4	CARRIAGE BOLT
3	2	3/8-16	HEX FLANGE NUT
4	2	CM-SP18	.250 x 1.00 x 2.00" SQUARE HOLE SPACER

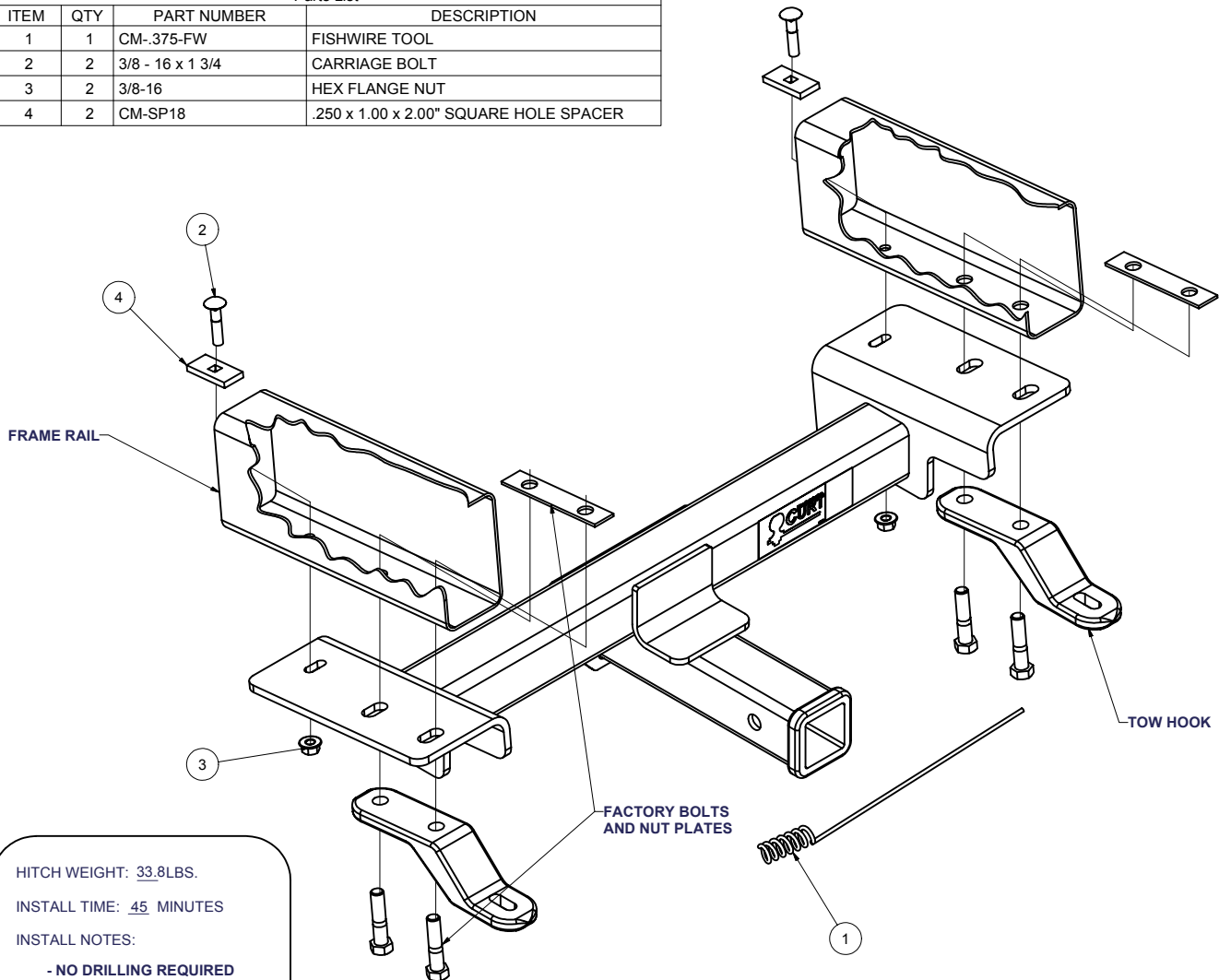

HITCH WEIGHT: 33.8LBS.

INSTALL TIME: 45 MINUTES

INSTALL NOTES:

- NO DRILLING REQUIRED
- FISHWIRE

INSTALLATION STEPS

**** skid plate may need to be notched or removed on some models. ****

- 1) Remove the factory tow hooks and set them aside with the bolts. Leave the existing nut plates inside the frame for final hitch installation.
- 2) Fishwire the 3/8" carriage bolts and spacers through the frame as shown.
- 3) Fasten the hitch to the frame using 3/8" flange nuts.
- 4) Reinstall the factory tow hooks by passing the factory supplied bolts thru the hook and hitch and then into the nut plates.
- 5) Torque fasteners 3/8" to 30 lb-ft. , 7/16" to 54 lb-ft. , 1/2" to 72 lb-ft. , 5/8" to 150 lb-ft.

PERIODICALLY CHECK THIS RECEIVER HITCH TO ENSURE THAT ALL FASTENERS ARE TIGHT AND THAT ALL STRUCTURAL COMPONENTS ARE SOUND.