

GROSS LOAD CAPACITY WHEN USED AS A WEIGHT CARRYING HITCH: 3,500 LBS. TRAILER WEIGHT & 350 LBS. TONGUE WEIGHT.
*****DO NOT EXCEED VEHICLE MANUFACTURER'S RECOMMENDED TOWING CAPACITY.*****

Parts List			
ITEM	QTY	PART NUMBER	DESCRIPTION
1	4	M10 - 1.25 x 30	HEX BOLT
2	4	7/16"	7/16 CONICAL TOOTHED WASHER
3	1	7_16 - 14 x 1.75" x 1.00" C-C	U-BOLT
4	2	7/16-14	HEX FLANGE NUT

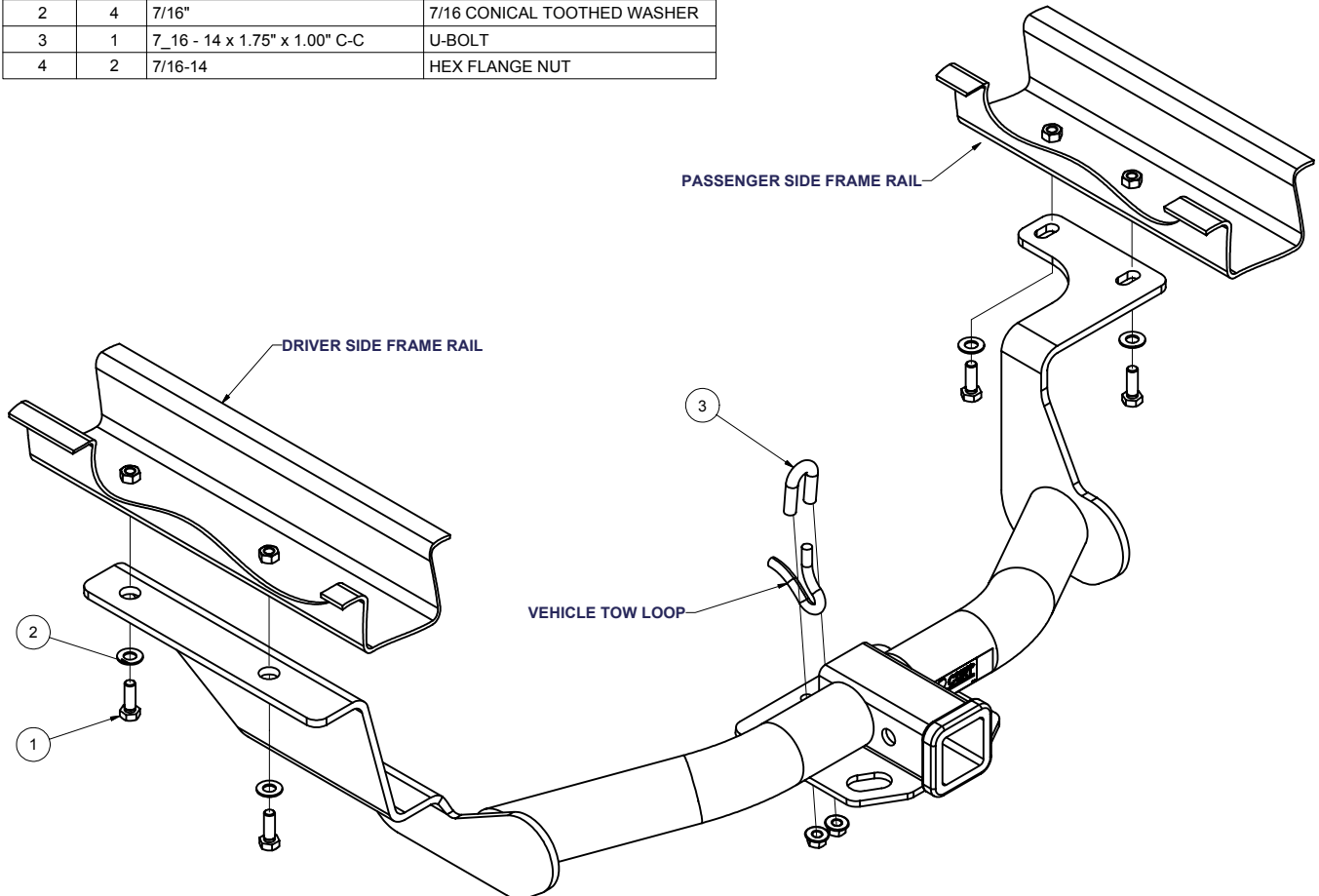

HITCH WEIGHT: 42 LBS.

INSTALL TIME: 45 MINUTES

INSTALL NOTES:

- NO DRILLING REQUIRED
- LOWER EXHAUST

INSTALLATION STEPS

- 1) Lower exhaust, (2) hangers above muffler.
- 2) Place ubolt into position through tow loop. Raise hitch into position, and install flange nuts onto u-bolt.
- 3) Install remaining fasteners as shown above.
- 4) Torque all 10mm fasteners to 37 lb-ft, and all 7/16" fasteners to 50 lb-ft.
- 5) Re-install exhaust hangers.

PERIODICALLY CHECK THIS RECEIVER HITCH TO ENSURE THAT ALL FASTENERS ARE TIGHT AND THAT ALL STRUCTURAL COMPONENTS ARE SOUND.

IMPORTANT!! Reference your vehicle owners manual before installation of any electrical components. Vehicle manufacturers often recommend additional precautions to protect sophisticated vehicle electronics.

INSTALLATION STEPS

- 1) Open rear hatch of vehicle. Lift spare tire well cover to install electrical converter and wiring.
- 2) Loosen plastic trim on driver side (trim located on the floor along the hatch opening.) Remove passenger and driver side tail light assemblies.
- 3) Place converter in spare tire well on driver side. Run all wires under the plastic floor trim panel. Run the long single green wire along the rubber hatch seal to passenger side taillight. Run short, single remaining wires along rubber seal to driver side tail light assembly. Install all wires as described in the diagram below. Leave 4-wire plug cord inside cargo area.



CONVERTER MOUNTING INSTRUCTIONS

- 1) After wires have been installed, locate the converter **SECURELY** in the spare tire well.

IMPORTANT - Make sure converter is positioned away from direct moisture and so spare tire will not interfere with unit.

- 2) Install ground wire with a sheet metal screw to inside metal surface of light housing.
- 3) After checking to ensure that all component in the system work properly, re-assemble vehicle trim.



WIRING DIAGRAM

CURT WIRING HARNESS NUMBER: I-55187

VEHICLE WIRE COLORS



BACK-UP LIGHT WIRE COLOR:

GREEN WITH BLACK STRIPE

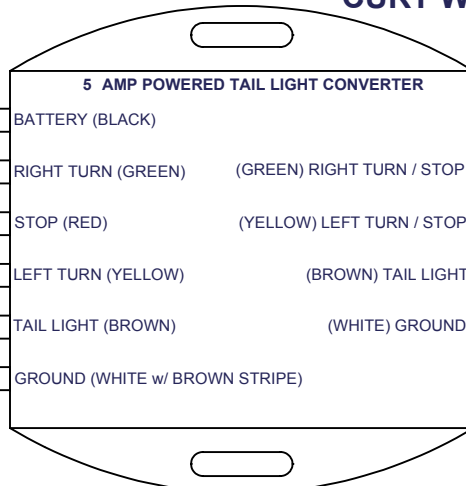

WIRING NOTES

SYSTEM: 3 WIRE
TURN BULB: E-4 2FG
BREAK BULB: 7443
INSTALLATION: TBD
RECOMMENDED TOOLS: 1/4" SOCKET SET, WIRE TESTER
SMALL AND LARGE STRAIGHT SCREW DRIVERS,