



**13334 DODGE NITRO, NITRO SLT, NITRO R/T**

10/11/06

GROSS LOAD CAPACITY WHEN USED AS A WEIGHT CARRYING HITCH: 3500 LBS. TRAILER WEIGHT & 350 LBS. TONGUE WEIGHT.  
 GROSS LOAD CAPACITY WHEN USED AS A WEIGHT DISTRIBUTION HITCH: 5000 LBS. TRAILER WEIGHT & 500 LBS. TONGUE WEIGHT  
**\*\*\*DO NOT EXCEED VEHICLE MANUFACTURER'S RECOMMENDED TOWING CAPACITY.\*\*\***

Parts List			
ITEM	QTY	PART NUMBER	DESCRIPTION
1	6	M12-1.75 x 45mm	HEX TAP BOLT
2	6	1/2"	CONICAL TOOTHED WASHER

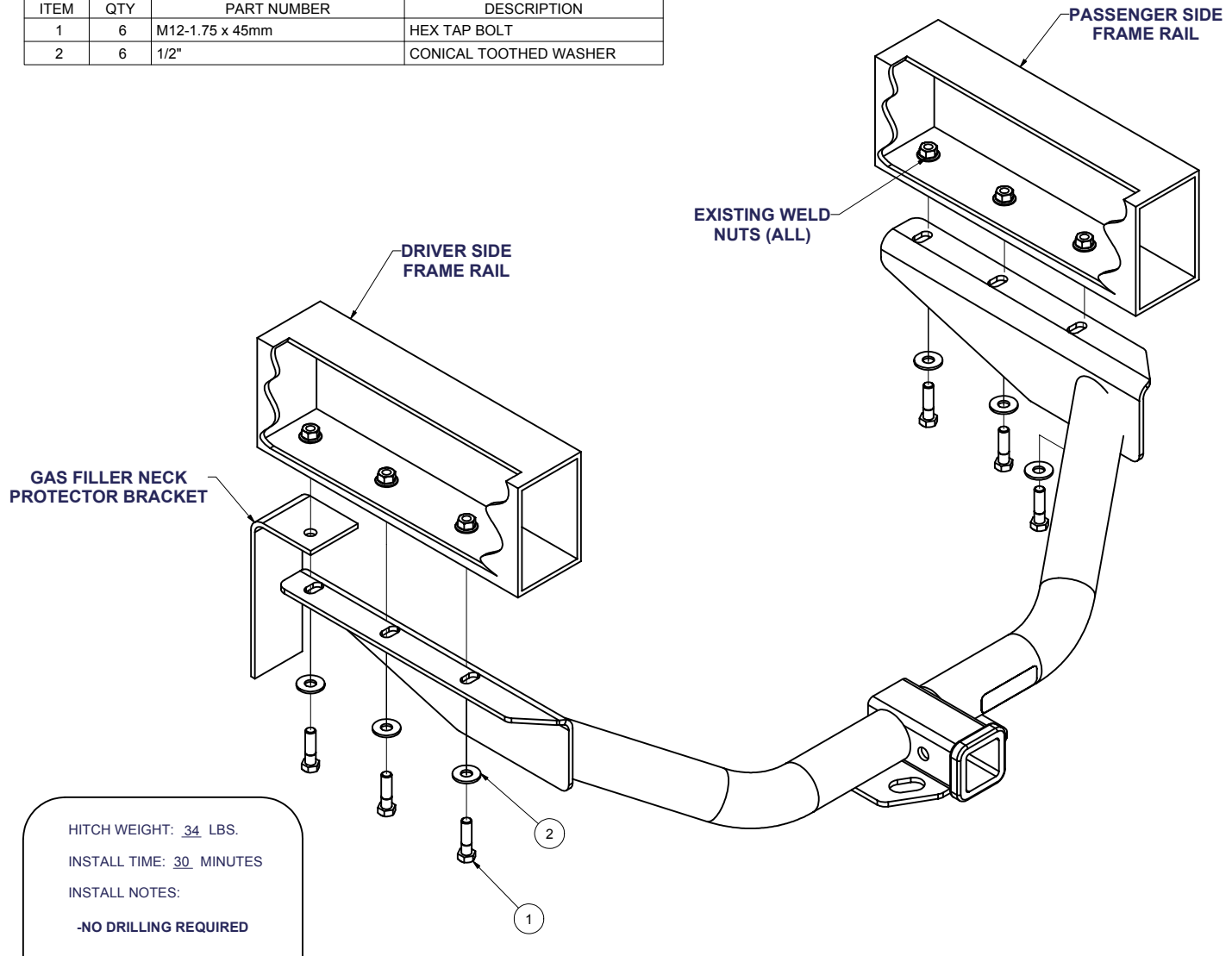

HITCH WEIGHT: 34 LBS.  
 INSTALL TIME: 30 MINUTES  
 INSTALL NOTES:  
 -NO DRILLING REQUIRED

**INSTALLATION STEPS**

- 1) Remove the tow hook from bottom of driver side vehicle frame. Discard the attaching bolts and tow hook. Remove the bolt holding gas filler neck protector bracket to frame.
- 2) Raise hitch into position with gas filler neck protector bracket between hitch and frame and align holes in hitch to the holes in frame as shown.
- 3) Fasten hitch to frame with M12 bolts and 1/2" conical toothed washers. Finger tight only.
- 4) Torque all M12 bolts to 65 ft.-lbs.
- 5) Return tow hook to customer.

**PERIODICALLY CHECK THIS RECEIVER HITCH TO ENSURE THAT ALL FASTENERS ARE TIGHT AND THAT ALL STRUCTURAL COMPONENTS ARE SOUND.**

Curt Manufacturing Inc., warrants this product to be free of defects in material and/or workmanship at the time of retail purchase by the original purchaser. If the product is found to be defective, Curt Manufacturing Inc., may repair or replace the product, at their option, when the product is returned, prepaid, with proof of purchase. Alteration to, misuse of, or improper installation of this product voids the warranty. Curt Manufacturing Inc.'s liability is limited to repair or replacement of products found to be defective, and specifically excludes liability for incidental or consequential loss or damage.

**IMPORTANT!!** Reference your vehicle owners manual before installation of any electrical components. Vehicle manufacturers often recommend additional precautions to protect sophisticated vehicle electronics.

**INSTALLATION STEPS**

- 1) Open rear hatch for access to door seal.
- 2) Loosen plastic trim along bottom of hatch (for running wire from driver side to passenger side). Remove passenger and driver side taillight assemblies, as shown in picture below.
- 3) Place converter in recess behind driver side taillight as shown below. Run the long single green wire from the converter to the passenger side tail light (poke it between the hatch seal and the frame, run under the plastic trim and through the seal on the other side.) The rest of the wires will attach to the driver side taillight. Install all wires as described in the diagram below. Run the 4-wire plug behind the hatch seal, and leave inside the cargo area.



**CONVERTER MOUNTING INSTRUCTIONS**

- 1) After wires have been installed, locate the converter SECURELY to the vehicle.
- IMPORTANT** - Make sure converter is positioned away from direct moisture and so taillight will not interfere with unit.
- 2) Install ground wire with a sheet metal screw to inner metal surface of light housing.
  - 3) After checking to ensure that all components in the system work properly, reassemble vehicle trim.

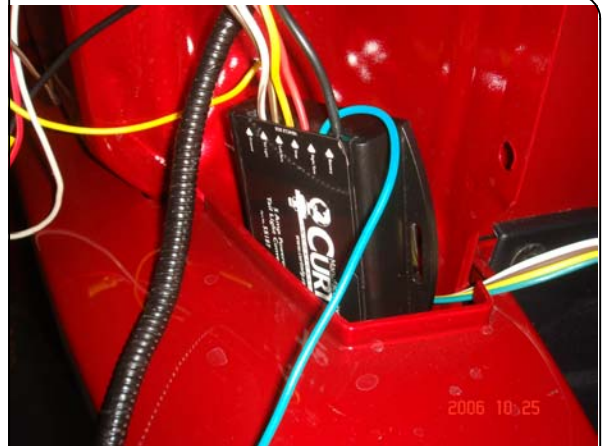

**WIRING DIAGRAM**

**CURT WIRING HARNESS NUMBER: I-55187**

**VEHICLE WIRE COLORS**

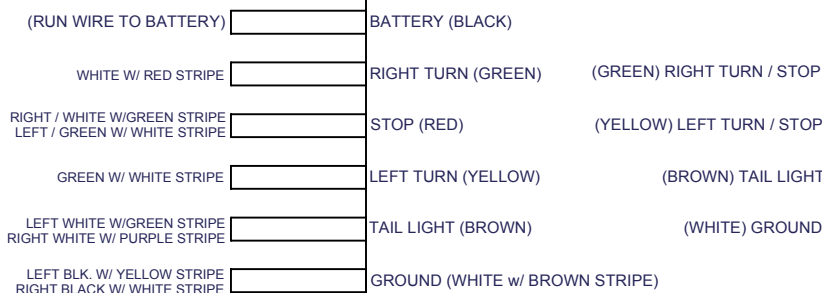

**BACK-UP LIGHT WIRE COLOR:**

WHITE W/ GREEN STRIPE

**WIRING NOTES**

SYSTEM: 3 WIRE  
TURN BULB: NA  
BRAKE BULB: NA  
INSTALLATION: BEHIND DRIVER SIDE TAILLIGHT  
RECOMMENDED TOOLS: 1/4" SOCKET SET, WIRE TESTER  
SMALL AND LARGE STRAIGHT SCREW DRIVERS,